

### 18 Gauge Stainless Steel Worktable with Splash Guard

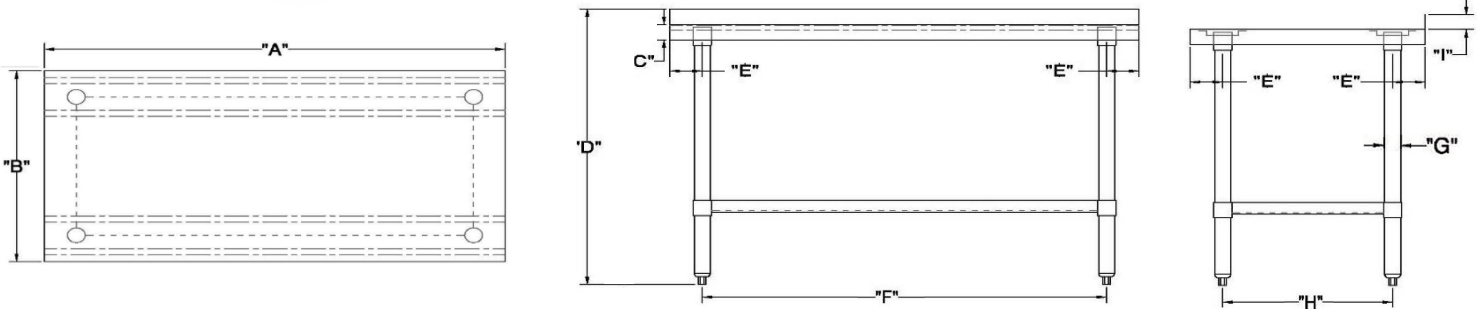

- Made of 18-gauge, 304 stainless steel
- 18-gauge, type 430 stainless steel undershelf adds stability and some much-needed storage space
- 1" Adjustable stainless steel bullet feet for added stability
- A 2" (1) tall backsplash is included to keep your walls clean



ITEM	TABLE LENGTH (A)	TABLE DEPTH (B)	TABLETOP THICKNESS (C)	OVERALL HEIGHT (D)	OVERHANG 7k\ U Q 8 #uk (E)	Q 8 ‡ @ u= (G)	FRONT-BACK LENGTH (H)	RIGHT-LEFT LENGTH (F)
SWWTS-2424-2R-318	24"	24"	2"	34"	3"5/16'	1"5/8'	17"3/8'	17"3/8'
SWWTS-2430-2R-318	30"	24"	2"	34"	3"5/16'	1"5/8'	17"3/8'	23"3/8'
SWWTS-2436-2R-318	36"	24"	2"	34"	3"5/16'	1"5/8'	17"3/8'	29"3/8'
SWWTS-2448-2R-318	48"	24"	2"	34"	3"5/16'	1"5/8'	17"3/8'	41"3/8'
SWWTS-2460-2R-318	60"	24"	2"	34"	3"5/16'	1"5/8'	17"3/8'	53"3/8'
SWWTS-2472-2R-318	72"	24"	2"	34"	3"5/16'	1"5/8'	17"3/8'	65"3/8'